

FOR MORE INFORMATION,  
PLEASE CONTACT OUR MEETING CONSULTANTS.  
TEL: +86 898 8871 6666 FAX: +86 898 8871 0099

[rosewoodhotels.com](http://rosewoodhotels.com)

ROSEWOOD  
SANYA

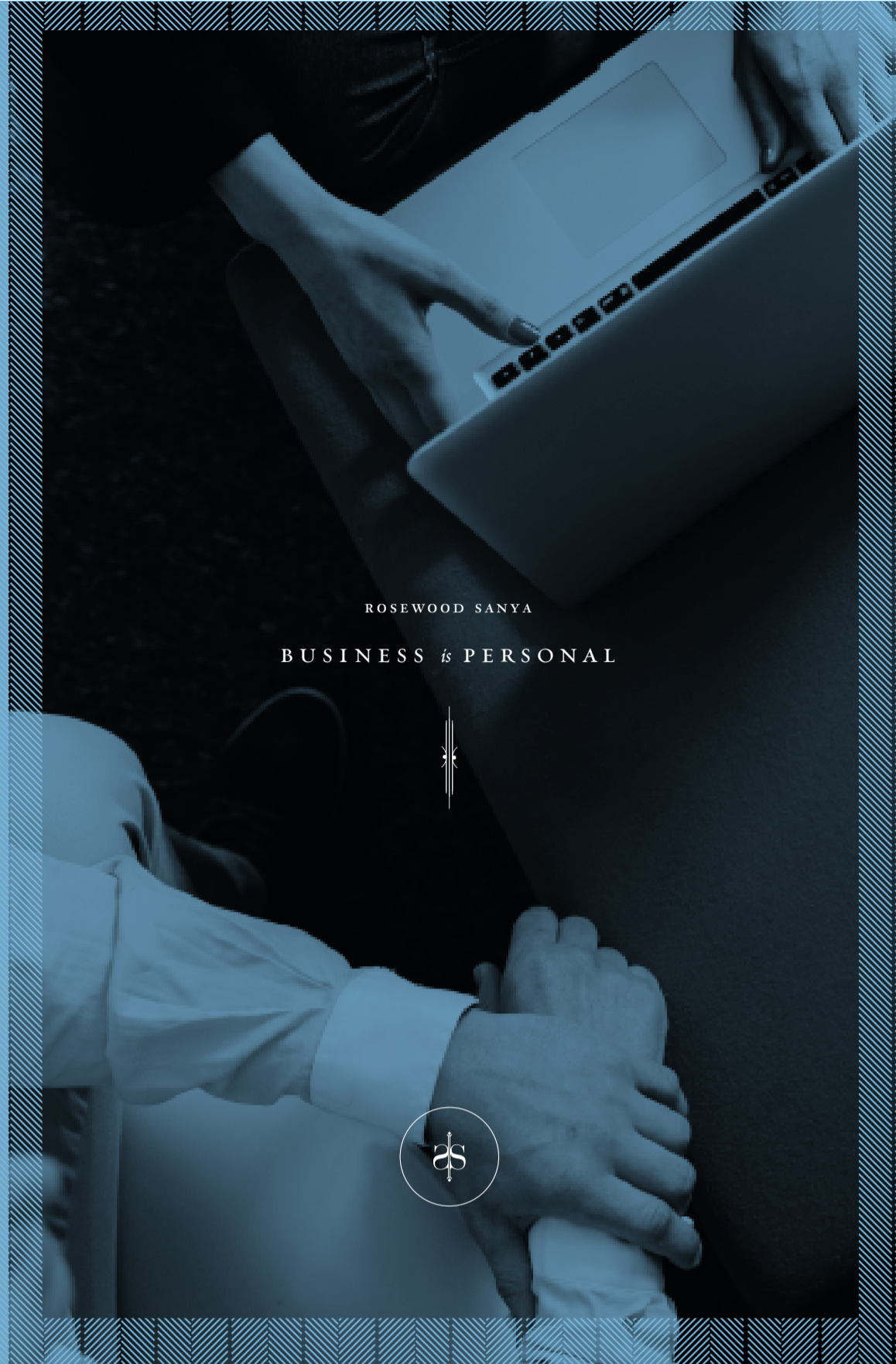

ROSEWOOD SANYA

BUSINESS *is* PERSONAL



ROSEWOOD SANYA, the first resort in China for Rosewood Hotels & Resorts® expresses the group's A Sense of Place® philosophy with architecture and design elements that showcase the breathtaking natural beauty of Hainan Island while reflecting its traditional history and culture. With exquisite accommodations and enchanting event spaces overlooking the crystal blue waters of Haitang Bay, Rosewood Sanya's location, along with its incredible cuisine and impeccable service, promise meetings, events and celebrations filled with luxury, inspiration, and good taste.

MEETINGS & FUNCTIONS

3,425 SQ. M.  
(36,866 sq. ft.)

UP TO  
3,000 GUESTS.

THE PAVILION

520 SQ. M.  
(5,597 sq. ft.)

UP TO  
500 GUESTS.

Meetings & Events

LOCATION

Rosewood Sanya is perfectly situated alongside Haitang Bay in one of the most coveted areas on Hainan Island. It is just a brief walk from the Sanya Forum Exhibition Hall, 28 kilometers from Sanya City, and 38 kilometers from Sanya Phoenix International Airport.

MEETINGS

Impeccably designed and superbly stylish, Rosewood Sanya's versatile meeting and function space totals 3,425 sq. m. (36,866 sq. ft.), including a pillar-less ballroom of 1,500 sq. m. (16,145 sq. ft.), and six multi-functional salons.

THE PAVILION

This elegant and artfully appointed residential-style venue features its own private entrance, living room, dining area with a show kitchen, board room, VIP room, and ocean view terrace with lush gardens. A total area of 520 sq. m. (5,597 sq. ft.) can accommodate up to 500 guests.

SERVICE

Rosewood Sanya's experienced meetings and events professionals provide highly personalized service that is caring, respectful and perfectly timed. From intimate business meetings to large-scale conferences or exhibitions, our team excels at menu tailoring, floral design and venue set up flexibility. Using a private Event Studio on the property, organizers can preview the event via the five senses of sight, sound, touch, taste and smell. Our team reviews the venue prior to the event, remains on site to troubleshoot, and liaises with all operating departments to ensure that every event is a resounding success.

CUISINE

Each meeting or event at Rosewood Sanya is a journey filled with sophistication and epicurean delights. Our cuisine features local seafood, and traditional Chinese, Asian and European-inspired dishes, designed by our renowned chefs and customized for every function.

TECHNOLOGY

Rosewood Sanya offers state-of-the-art audiovisual equipment and technology, from simultaneous translation to satellite,teleconferencing, and more.

BEACH LAWN

With stunning panoramic views over the white sand beaches and sparkling South China Sea, the sophisticated Beach Lawn is bordered by verdant foliage to create a magical ambiance for breathtaking ceremonies and extravagant cocktail receptions.

# CAPACITY CHART & FLOOR PLANS

	SQM	SIZE(M)	HEIGHT(M)	RECEPTION	THEATRE	CLASSROOM	LONG TABLE	ROUND TABLE	U-SHAPE
SALON 1	155	13 X 12	4	50	120	50	-	90	30
SALON 2	155	13 X 12	4	-	250	-	-	-	-
SALON 1+2	310	26 X 12	4	100	-	100	-	190	60
GRAND BALLROOM	1,500	32 X 47	8	2,500	2,000	1,000	-	1,500	-
GRAND BALLROOM 1	500	32 X 16	8	700	700	250	-	500	-
GRAND BALLROOM 2	500	32 X 16	8	700	700	250	-	500	-
GRAND BALLROOM 3	500	32 X 16	8	700	700	250	-	500	-
GRAND BALLROOM 1+2	1,000	32 X 32	8	1,500	1,400	600	-	1,000	-
GRAND BALLROOM 2+3		32 X 32	8	1,500	1,400	600	-	1,000	-
SALON 3	105	8 X 13	4	50	60	36	-	40	30
SALON 4	105	8 X 13	4	50	60	36	-	40	30
SALON 5	105	8 X 13	4	50	120	36	-	40	30
SALON 3+4	210	13 X 16	4	100	120	72	-	80	60
SALON 4+5	210	13 X 16	4	100	250	72	-	80	60
SALON 3+4+5	315	24 X 13	4	150	60	108	-	120	60
SALON 6	90	11 X 8	3.5	-	-	-	-	-	20
THE PAVILION	1,120	-	-	600	200	80	-	200	46
TERRACE	600	44 X 14	-	100	-	-	-	-	-
BOARDROOM	130	12 X 11	5	-	-	-	-	-	16
VIP ROOM	150	12 X 13	5	-	-	-	-	40	-
DINING	240	20 X 12	5	500	200	80	-	180	30
LAWN 1	1,100	38 X 29	-	1,000	-	-	240	500	-
LAWN 2	700	32 X 22	-	500	-	-	140	250	-
LAWN 3	1,100	32 X 35	-	1,000	-	-	180	500	-
LAWN 4	1,600	52 X 31	-	1,200	-	-	200	600	-
LAWN 5	800	31 X 26	-	600	-	-	84	300	-
LAWN 6	400	29 X 14	-	200	-	-	60	150	-

## 1ST FLOOR

### GRAND BALLROOM/SALONS

The Grand Ballroom is a venue designed for spectacular occasions and can also be separated into three junior ballrooms. Salon 1&2, the dedicated chairman's salon and bridal suite are also available upon request.

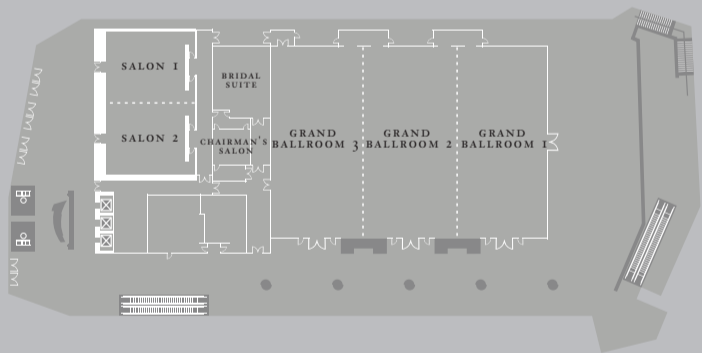

## 3RF FLOOR

### THE PAVILION

This impeccably designed residential-style venue features two combinable areas for uniquely memorable events with dining spaces, boardroom, VIP room, show kitchens and an expansive outdoor terrace and garden.

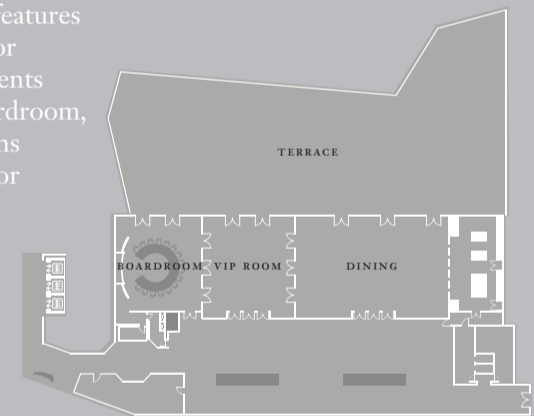

## 1ST FLOOR

### BRIDAL SUITE AND CHAIRMAN'S SALON

The Bridal Suite and Chairman's Salon are synonymous with elegance, exclusivity and relaxation. This spacious suite and salon are beautifully furnished and feature their own private bathrooms and dressing areas for the ultimate privacy.



## 1ST FLOOR

### BEACH LAWN

The sophisticated Beach Lawn is bordered by verdant foliage to create a magical ambiance for breathtaking ceremonies and extravagant cocktail receptions.

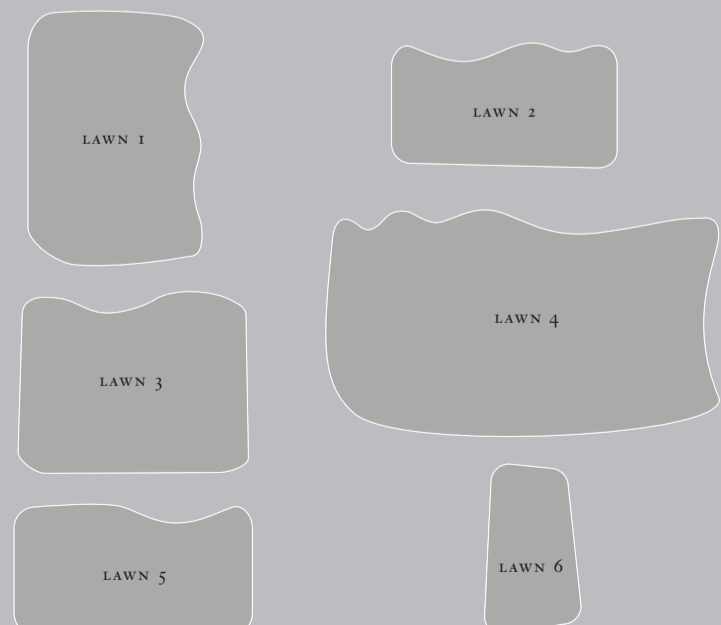

## 2ND FLOOR

### SALONS

All function rooms are fully equipped with the highest standard of technology to ensure seamless presentations and discussions.

